

YH01L-03HTBY Heating Programmable

Digital Thermostat

INTRODUCTION

03HTB is designed with microcomputer intelligent logic technology and used to control indoor temperature, which could set time, control temperature and also has over temperature control selection. It is applicable for adjustment on constant temperature in electric heating system.

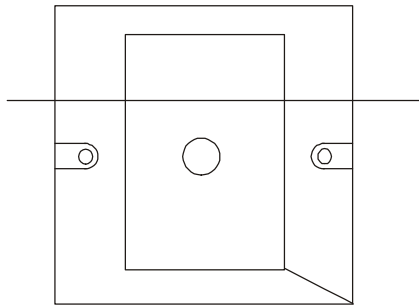

Installation Box on the wall: 86x86x60MM

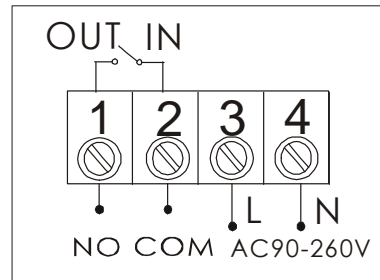

Wire Connection

CHARACTERISTIC

1. Digital LCD display of room ambient temperature and user selected temperature setting on demand.
2. Attractive modern styling and smart out-looking
3. Manual operation available;
4. Daily programs with separate 7 day settings
5. Low temperature protection (In any conditions, the temperature would be no less than 5°C).

6. Digital LCD display, Blue or Orange Backlight
7. Guards against the rime function.
8. Data Memory: If the power cut off accidentally, it could be continuing to work by order if the power returns.
9. Adjustable manual 3-speed or automatic fan speed control, High, Medium and Low.
10. Fahrenheit and centigrade temperature mode selectable
11. Sleep function: Comfortable temperature, economical, power and energy saving.
12. Setting-point range: 5~60°C; display range: 1-90°C; Accuracy: $\pm 1^\circ\text{C}$. When heat sensor is shut off, it will display E1.
13. Built-in Clock functions with display for automatic comfort and setback temperature.

TECHNIQUE PARAMETERS

1. Power supply: 220V/AC $\pm 10\%$, 50HZ
2. Load current: 12A
3. Power consumption: $\leq 2\text{W}$
4. Rated Current: 3A
5. Set-point Range: 5-60°C
6. Temperature control Accuracy: $\pm 1^\circ\text{C}$
7. Relative Humidity: <85% (no condensing)
8. Dimensions: 86x86x13mm
9. Size of display: 66mm x 46mm (H/W)
- 9: Material and color: milk white ABS fire-proofing plastics.

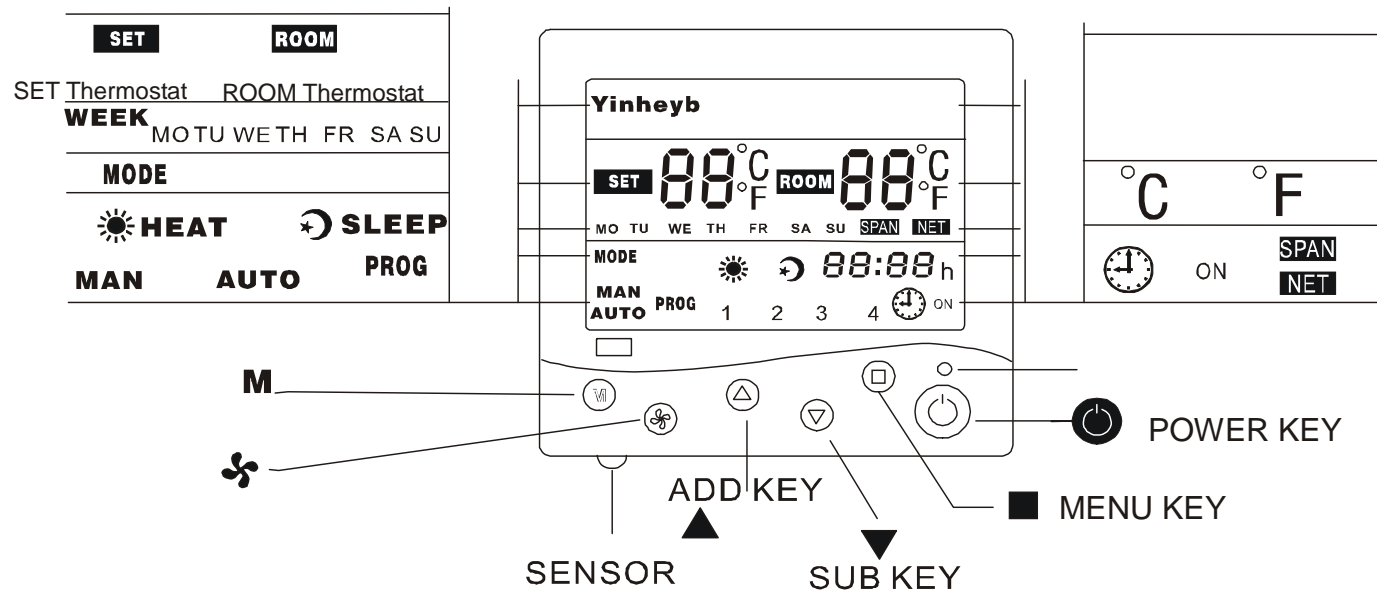

INSTALLATION

1. Please strictly follow the wiring diagram to arrange the wires and don't let the water, slop and other substance into the machine, or the components would be easily damaged.
2. Choose proper installation location. (Don't place it toward sunshine or under water conditions)
3. Before work, please make sure some necessary protection on leakage.
4. Working Temperature: -10°C-+50°C
5. Relative Humidity: <85% (no condensing)
6. If it is installed in wash room, please cover with the special water-proof mask.

FACTORY SETTING

Mode: Heating

Temperature setting: Random

Manual Operation

No timing and sleeping function;

Automatically turn on when connected with power

OPERATION DIRECTIONS

- ▲ Rise Temperature or set up menu
- ▼ Reduce Temperature or set up menu

1. Power ON/OFF:

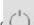
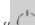
“” The systematic switch, press “” to choose the state of be ON or be OFF.

2. Set temperature:

Press the key “▲” to set temperature to be up, press the key “▼” to set temperature to be down, change 1°C one time (only effective in the current time. Adjust the time, ON/OFF and revise 7 days program, temperature will be reset.)

3. Adjust Clock.

Press the key “■”, until the “hh” of “hh:mm” twinkle, “▲” set hour to be up and “▼” to be down.

Press the key “■”, until the “mm” of “hh:mm” twinkle, “▲” set minute to be up and “▼” to be down.

Press the key “■”, until the week twinkle, “▲” “▼” to set week.

4. Operation Mode.

Press menu button “■” to select Auto or Manual. Use Button “▼” you will enter the manual mode and “▲” for auto mode.

5. Sleep Mode.

In manual mode, press button “■”, you could start the setting on sleep function. Press “▲”, it will turn into the sleeping mode. And press “▼”, cancel this mode.

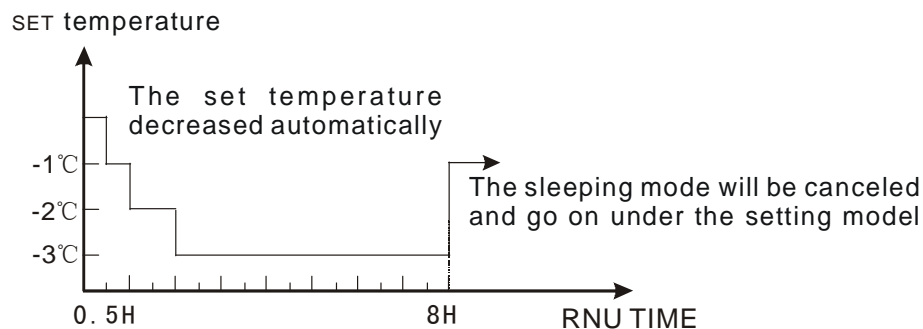

Work drawing on sleeping mode when heating

6. Time set-up on auto ON/OFF power

Press “■”, you could start to set up time for auto power on. At this moment, you will see “⌚” twinkle on the displayer, use “▲▼” for hour and minutes setting and “✿” to set up date.

Press “■”, you could start to set up time for auto power off. At this moment, you will see “⌚” twinkle on the displayer, use “▲▼” for hour and minutes setting and “✿” to set up date.

After all the setting, press the menu button “■” again, you could exit the function setting.

During your setting, if you want to end up, press button  is ok.

7. Programming on time and temperature

In Auto mode, Press button “■” more than 5 seconds, you will see “Monday to Friday”、“Program 1” twinkle, press button ▲ and ▼ for temperature adjustment.. Press “M” to set up hour and “✿”for minutes. Then press button “■” again, you could set the second, third, fourth program one by one as above described method. When finishing all the setting on weekday, you will enter into the setting for weekend (Saturday and Sunday) by the same way.



8. Pre-set Program

Temperature controller: weekday (Monday to Friday), weekend (Saturday, Sunday) with 4 programs. They could be easily set up. Press the button “■” over 5 seconds. It will display the program on temperature and time at the beginning. Continue to press this button; you could see the four programs on Saturday and Sunday.

No	Time	Heat setting temperature for weekday	Heat setting temperature for weekend
Program 1	6:00	21 °C	21 °C
Program 2	8:30	21 °C	21 °C
Program 3	16:00	21 °C	21 °C
Program 4	23:00	17 °C	18 °C

9. Setting on over temperature and other functions

When the thermostat is connected with power, but you don't start it up, press “M” over 5 seconds, then you would see the picture 1. Press “▲▼” to start or shut off the over-temperature protection. Press button “■”, the LCD will show picture 2, use button “▲▼” to set up the auto start-up when the power returns or not. Continue to press the button “■”, (see picture 3), ▲ display, ▼ No display. Go on to press this button, you will enter the selection on Fahrenheit and centigrade temperature

mode. (See picture 4). Return to press menu button “■”, come into the selection on low temperature protection, then press button ▲ and ▼ to set up. Press “■” to set up the external sensor temperature (See Picture 6).

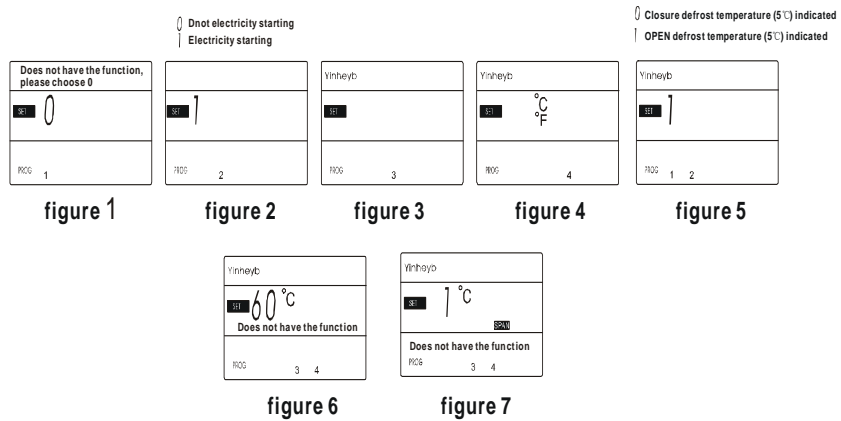

Note: In auto mode, no sleep and timing function.

Setting on the temperature controlling difference

The range for temperature controlling in factory setting is 1 °C。 For example: if the setting temperature is 20 °C, the heater would power off at this temperature and start up on 19 °C. But this range is adaptable. You could choose between 1 °C、 2 °C、 3 °C、 4 °C and 5 °C.